

MELLIN & ASSOCIATES  
ARCHITECTS, P.C.  
5970 East Yale Avenue  
Littleton, CO 80120  
Phone: 303-681-2946  
Fax: 303-758-1889

© MELLIN & ASSOCIATES ARCHITECTS, P.C.

**CONSULTANTS:**

**STRUCTURAL ENGINEER**  
Structural Design Group  
12155 West Dryden  
Suite 102  
Littleton, CO 80128  
303-504-4888  
Contact: Dan Sandquist P.E.

**MECHANICAL ENGINEER**  
GIVEN & ASSOCIATES, INC.  
735 South Xenon Ct  
Littleton, CO 80120  
303-716-1270  
Contact: Jeff A. Given P.E.

**ELECTRICAL ENGINEER**  
Allen Engineering Inc  
10489 Bradford RD #102  
Littleton, CO 80127  
303-988-3280  
303-989-2534 Fax  
Contact: Catherine Bernall

ALL WORK DELETED  
BY OWNER

ALL WORK DELETED  
BY OWNER

**GENERAL NOTES**  
GENERAL CONTRACTOR SHALL PROTECT ALL EXISTING ROOFING TO REMAIN. ANY DAMAGE TO EXISTING ROOFING SHALL BE REPAIRED OR REPLACED WITH SAME MATERIALS AND CONSTRUCTION TO MATCH ORIGINAL SURFACES.

- KEYNOTES - ROOF PLAN A-7**
- THREE PLY WOODED BRUIEN MEMBRANE ROOFING: A 3 PLY WOODED SYSTEM ON 1/2" COVER BOARD, 1/2" OF POLY-ISO BOARD ON 1 1/2" (ACOUSTIC OR NON-ACOUSTIC) METAL DECK. SLOPE ROOF TO INTERIOR ROOF DRAINS. REFER TO SPECIFICATIONS AND ROOF DETAILS FOR RELATED INFORMATION.
  - PROVIDE ADDITIONAL ROOF INSULATION THICKNESS AS REQUIRED TO MEET ROOF SLOPE INDICATED AND TO TOP OF INSULATION INDICATED.
  - STANDARD SHIP FABRICATED, 24 GAUGE, GALVANIZED METAL COPING, WITH KYNAR 500 METALLIC FINISH. COLOR EQUAL TO ZINC-COTE. BY BERTRIDGE MANUFACTURING COMPANY.
  - INSTALL ROOF EXPANSION JOINT FLASHING AND COUPLER FLASHING WHERE NEW PARAPET ABUTS EXISTING BUILDING. REFER TO ROOF DETAILS FOR RELATED INFORMATION.
  - INTERIOR ROOF DRAIN AND OVERFLOW DRAIN SHALL BE AS INDICATED IN SIZE. REFER TO ROOF DETAILS. INSTALL OVERFLOW DRAIN 1/2" ABOVE ROOF DRAIN HEIGHT. PER CODE. REFER TO DETAILS FOR RELATED INFORMATION.

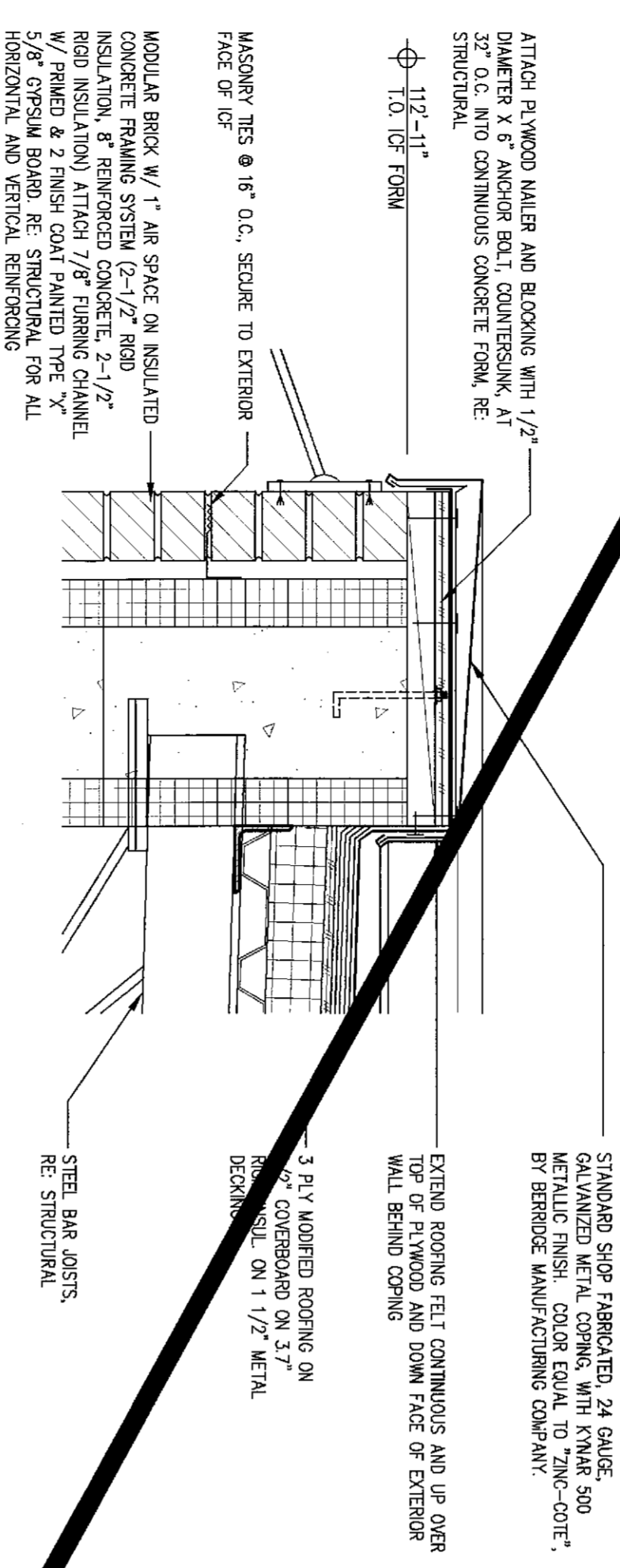

**3 PARAPET DETAIL**  
SCALE: 1-1/2" = 1'-0"

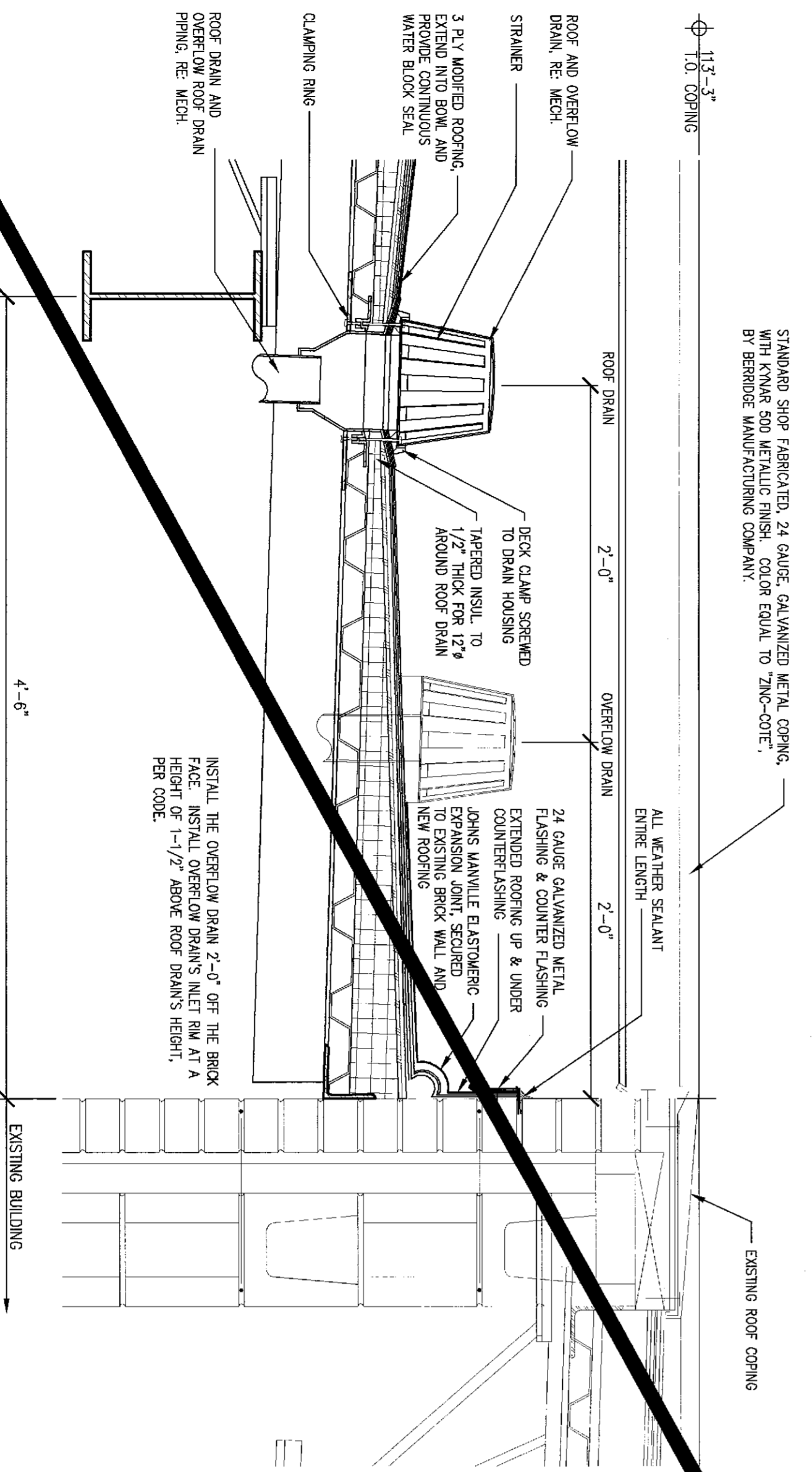

**2 PARAPET DETAIL**  
SCALE: 1-1/2" = 1'-0"

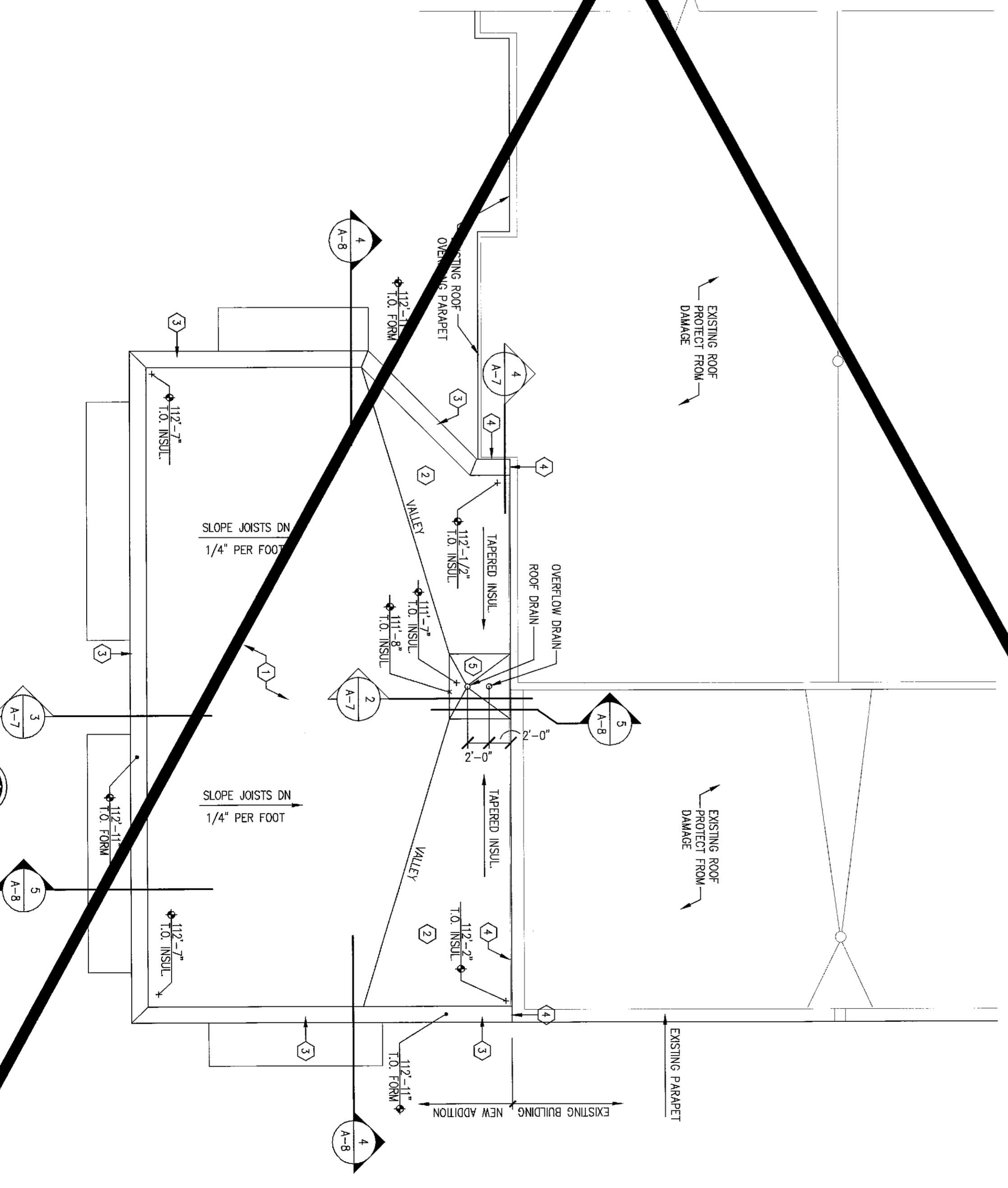

**1 ROOF PLAN**  
SCALE: 1/8" = 1'-0"

ALL WORK DELETED  
BY OWNER

**PROJECT TITLE:**

Classroom Addition &  
Cafeteria Renovation  
for  
Cache La Poudre  
Elementary School  
Poudre School District

ISSUED	REVISIONS
D.D.'s	04-06-06
93% C.D.'s	05-01-06
100% C.D.'s	05-08-06
RECORD DOCUMENTS	06-08-07

**TITLE**

ROOF PLAN

**A-7**

SHEET A-7 OF 24